

## Hotel Refit

**When 20,000 hotel rooms needed to hide cables for new heating controllers, D-Line Mini Trunking proved the perfect choice...**

Using D-Line saved a small fortune compared to the cost of channelling the walls then re-plastering and re-decorating.

Aside the noise and disruption, trying to recess the cabling would have put rooms out-of-service. However traditional trunking did not look suitable for a hotel chain with a reputation for comfort and style.

Cables fed from wall mounted heaters to wall mounted controllers were concealed in D-Line Mini Trunking which blended with the skirting and, when necessary, up-and-around bedheads.

A cut-length rose up to the heater via a clip-over Equal Tee, while clip-over Internal Bends made internal corner connections quick and easy. The Flat Bend required was the smooth-fit version, as the secure internal tabs were favoured to eliminate future maintenance concerns, given that this part was most likely to be bumped by guests' baggage.

The ½ round shape of the length rising up to the wall-mounted controller was preferred also for its impact resistance, the lack of sharp edge a distinct benefit (compared to traditional sharp edge trunking).

The D-Line Cutting Tool was used throughout, saving time and leaving no dust.

The self-adhesive tape was used to attach the lengths to the walls, with a screw-fixing and plug then inserted 750mm from each end.

The result was 20,000 installations using 200km - all easy to fit, quick to install and blending with decor. Further details on request.



### Unique Clip-Over Accessories

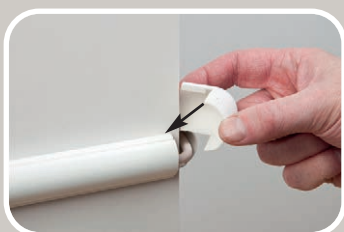

### Saves Channelling Walls



### Quick and Easy to Fit

